



ITALIAN TORQUE WRENCH

Durable torque wrenches
for precise tightening.

TORQUE WRENCHES 810 SA - 811 SA WITH DIRECT READ SYSTEM.



REVERSIBLE RATCHET
with 72 theet mechanism.

CLICK TORQUE SYSTEM
with compression spring.

SEALED MECHANISM.
TOP OF RESISTANCE.

ADJUSTMENT RING
with automatic return.

CONICAL HANDLE
in anti-slip bimaterial.

IP 51

DUST AND WATER
PROTECTION

810 SA

ISO 6789

Direct read torque wrench with reversible ratchet IP 51

- Calibration certificate and REACH (SVHC) declaration included.

ITEM	CODE	CAPACITY	☑	L	RESOL.
810 SA 50	U08105102	10÷50 Nm	3/8"	350 mm	0,25
810 SA 100	U08105103	20÷100 Nm	1/2"	410 mm	0,5
810 SA 200	U08105105	40÷200 Nm	1/2"	475 mm	1,0
810 SA 340	U08105106	60÷340 Nm	1/2"	630 mm	1,0

811 SE

ISO 6789

Direct read torque bar

- Calibration certificate and REACH (SVHC) declaration included.

ITEM	CODE	CAPACITY	☑	☐	L	RESOL.
811 SE 50	U08115012	10÷50 Nm	3/8"	9x12	370 mm	0,25
811 SE 100B	U08115013	20÷100 Nm	3/8"	9x12	430 mm	0,5
811 SE 100C	U08115015	20÷100 Nm	1/2"	9x12	430 mm	0,5
811 SE 200	U08115017	40÷200 Nm	1/2"	14x18	510 mm	1,0
811 SE 340	U08115018	60÷340 Nm	1/2"	14x18	665 mm	1,0



**CLOCKWISE
TIGHTENING**

ACCURACY
±4%

3/8"

1/2"

Removable
ratchet



**CLOCKWISE AND
COUNTERCLOCKWISE
TIGHTENING**

ACCURACY
±4%

3/8"

1/2"

RESISTANT LIKE FEW. EASY FOR EVERYONE.

In our Gemonio (VA) factory, we designed and created an innovative torque wrench that combines the extreme durability of our USAG ratchets with the ease of use of a direct torque reading system.

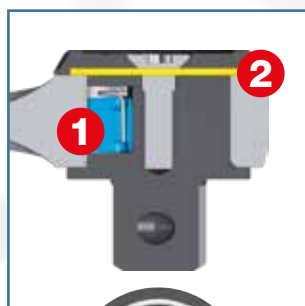

IP51 SEALED MECHANISM

1. High-strength pawl
2. Protective diaphragm

TOP PERFORMANCE

72-tooth mechanism with 5° adjustment.
Reversal system integrated into the lid.
Greater durability guaranteed by the sealed mechanism.
Extreme resistance to static torsion.

DIRECT TORQUE READING

You no longer need to learn how to combine the double scale graduated with tens and units. This system makes all torque regulation quick and easy. See the set value instantly, with **numbers 50% larger** than those on other wrenches on the market.

ADJUSTMENT RING

To set the torque, simply pull the ring back and rotate the handle. An additional locking system is no longer necessary: **the ring automatically returns to its seat** and keeps the wrench set to the desired torque.

SNAP MECHANISM

The internal compression spring is designed to maintain accuracy even after many uses. The 810 SA mechanism is tested by USAG to **withstand up to 25,000 cycles**: 5 times what is required by the ISO 6789 standard.



CLICK TORQUE BAR 811 LB

PERFECT MATCH OF ACCURACY AND RESISTANCE.

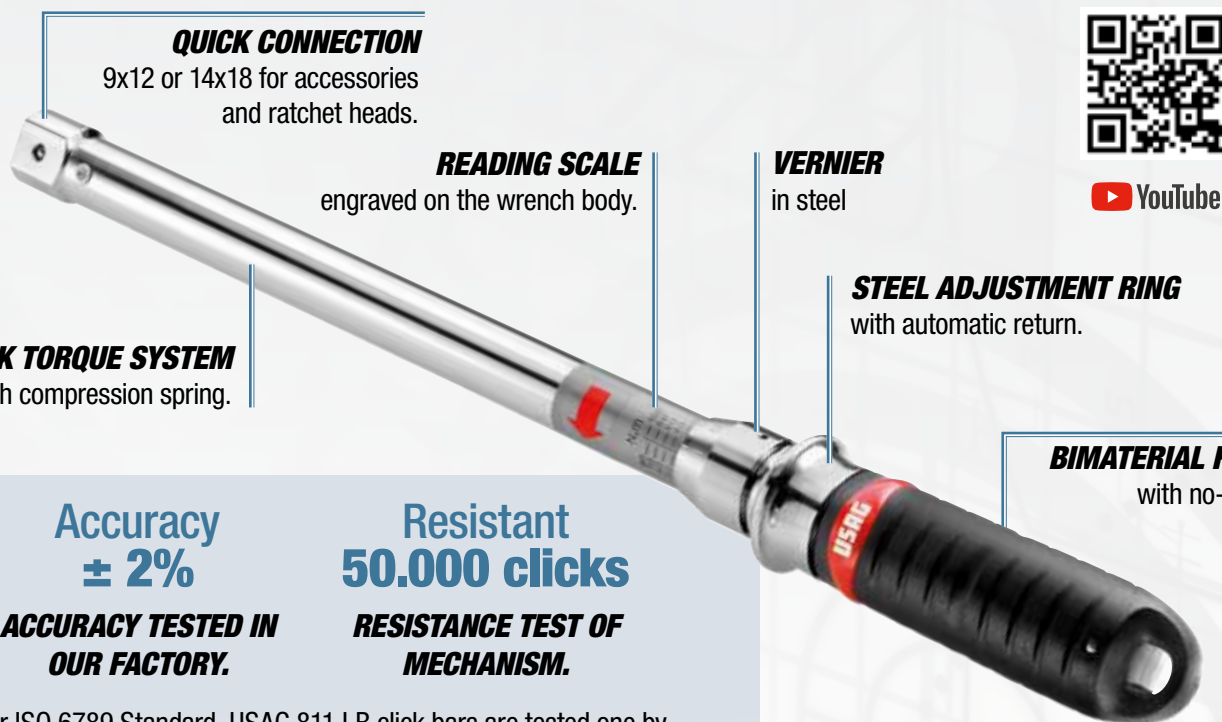

YouTube

QUICK CONNECTION

9x12 or 14x18 for accessories and ratchet heads.

READING SCALE

engraved on the wrench body.

VERNIER

in steel

STEEL ADJUSTMENT RING

with automatic return.

BIMATERIAL HANDLE

with no-slip grip.

CLICK TORQUE SYSTEM
with compression spring.

Accuracy
± 2%

**ACCURACY TESTED IN
OUR FACTORY.**

Resistant
50.000 clicks

**RESISTANCE TEST OF
MECHANISM.**

As per ISO 6789 Standard, USAG 811 LB click bars are tested one by one in production, before being packaged. These bars can keep an accuracy between $\pm 2\%$ and $\pm 4\%$, even after 5,000 tightenings.



**CLOCKWISE AND
COUNTERCLOCKWISE
TIGHTENING**

ACCURACY
±2%

811 LB ISO 6789

Click torque bar

ITEM	CODE	CAPACITY	□	L	RESOL.
811 LB 50	U08115021	10÷50 Nm	9x12 mm	357 mm	1 Nm
811 LB 100	U08115023	20÷100 Nm	9x12 mm	437 mm	1 Nm
811 LB 200	U08115024	40÷200 Nm	14x18 mm	515 mm	1 Nm
811 LB 350	U08115025	70÷350 Nm	14x18 mm	725 mm	2 Nm



Removable
ratchet

ACCURACY
±2%

3/8"

1/2"

**CLOCKWISE AND
COUNTERCLOCKWISE
TIGHTENING**

811 LBE ISO 6789

Click torque wrenches with removable ratchet

ITEM	CODE	CAPACITY	□	□	L	RESOL.
811 LBE 50	U08115026	10÷50 Nm	3/8"	9x12 mm	407 mm	1 Nm
811 LBE 100B	U08115027	20÷100 Nm	3/8"	9x12 mm	487 mm	1 Nm
811 LBE 100C	U08115028	20÷100 Nm	1/2"	9x12 mm	487 mm	1 Nm
811 LBE 200	U08115029	40÷200 Nm	1/2"	14x18 mm	565 mm	1 Nm
811 LBE 350	U08115032	70÷350 Nm	1/2"	14x18 mm	775 mm	2 Nm

TORQUE WRENCHES UP TO 25 Nm



**CLOCKWISE
TIGHTENING**

ACCURACY
±4%

**1
4**"

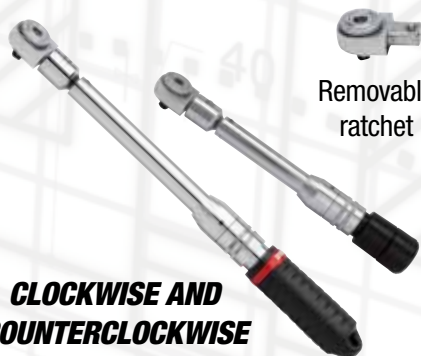

**CLOCKWISE AND
COUNTERCLOCKWISE
TIGHTENING**

Removable
ratchet

ACCURACY
±4%

**1
4**"

810 N

ISO 6789

Torque wrenches with reversible ratchet

- Sensible and audible alarm on reaching preset torque value
- Automatic resetting on pressure release after disengagement
- Supplied with test certificate

ITEM	CODE	CAPACITY	☑	L	RESOL.
810 N 5	U08104000	1÷5 Nm	1/4"	197 mm	0,05
810 N 25	U08104001	5 ÷ 25 Nm	1/4"	290 mm	0,05

811 NE

ISO 6789

Torque wrenches with removable reversible ratchet

- Adjustable torque model for use in combination with fittings from the 811-series
- Sensible and audible alarm on reaching preset torque value
- Automatic resetting on pressure release after disengagement
- Supplied with test certificate

ART.	CODE	CAPACITY	☑	□	L	RESOL.
811 NE 5	U08114009	1÷5 Nm	1/4"	9x12 mm	185 mm	0,05
811 NE 25	U08114010	5÷25 Nm	1/4"	9x12 mm	300 mm	0,05

TORQUE WRENCHES UP TO 1.000 Nm



**CLOCKWISE AND
COUNTERCLOCKWISE
TIGHTENING**

ACCURACY
±4%

**3
4**"

812 N

ISO 6789

Torque wrenches with reversible ratchet

- Adjustable torque model for clockwise and counterclockwise tightening by turning the ratchet 180°
- Accuracy ± 4% of the preset torque value
- Readings in Nm
- Sensible and audible alarm on reaching preset torque value
- Automatic resetting on pressure release after disengagement
- Safety block after setting torque
- Supplied in sheet steel box with test certificate

ITEM	CODE	CAPACITY	☑	□
812 N 600	U08120006	120 ÷ 600 Nm	3/4"	14x18 mm
812 N 1000	U08120010	200 ÷ 1000 Nm	3/4"	-



Join our channel

@USAGexport

Tutorial video,
new products
and much more!

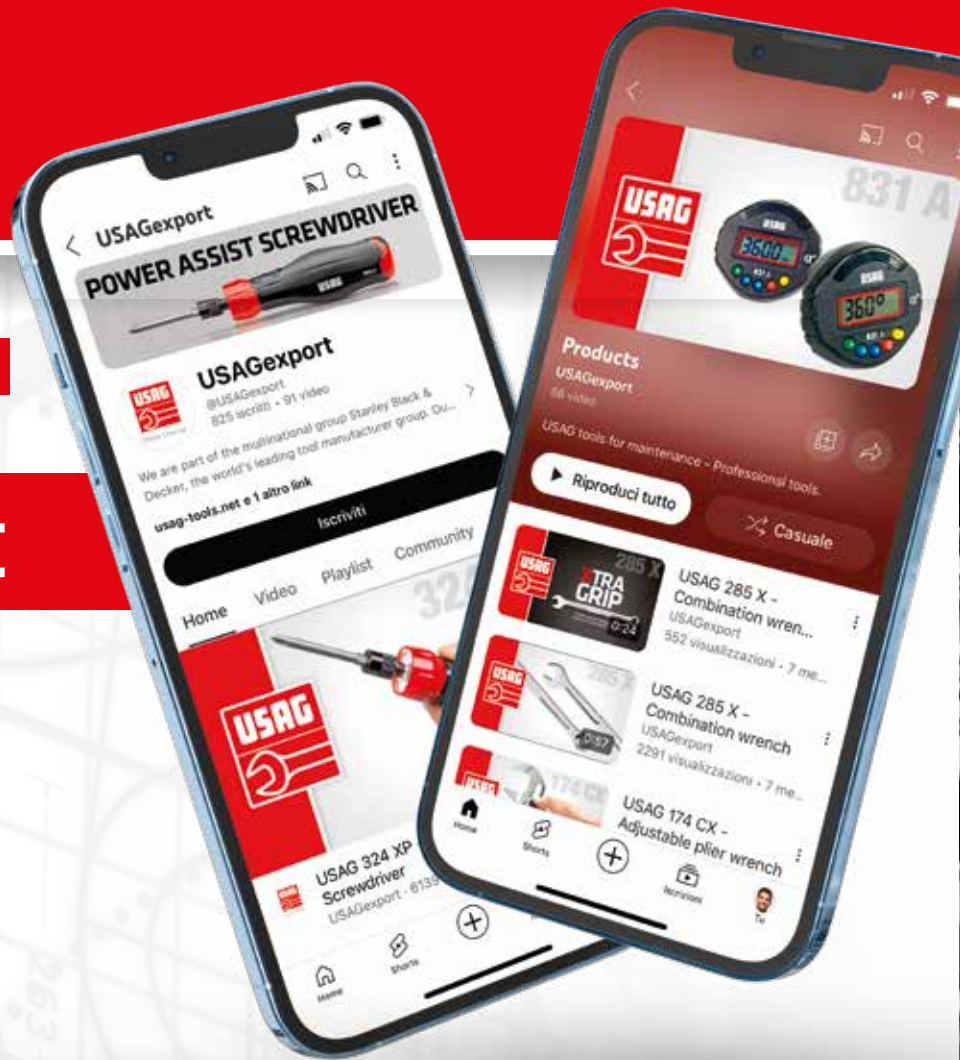

Do you need support from us?

Go to our website:



usag.it/en/contacts/support



The images shown in this catalogue are not binding.
Stanley Black & Decker italia S.r.l. reserves the right to change the technical characteristics of its products at any time.



Stanley Black & Decker Italia S.r.l.

Via Volta, 3 - 21020 - Monvalle (VA)
Tel. +39 0332 790 111 - info.mv@usag.it

usag-tools.net

